



方向把组件

1	left handle bar grip	602006-0015
2	multi functional switch	313001-0009
3	fat handle bar	602002-0020
4	throttle cable	602014-0021
5	belt	906003-0002
6	clutch lever (old with parking brake)	602009-0007
	clutch lever (new no parking brake)	602007-0028
7	throttle perch	602011-0007
8	parking cable	602016-0006
9	clutch cable	602013-0019



前制动总成

1	front brake assy	404000-0088
1-1	front brake pads	404007-0013
1-2	front brake bracket	404008-0012
1-3	front brake lever	404002-0017
1-4	front brake upper pump assy.	404003-0010
1-5	front brake oil pipe	404005-0016
1-6	front brake bottom pump assy.	404006-0013
2	flange bolt	903019-0014-02
3	flange locknut	903007-0004-02
4	flange nut	903018-0011
5	spring washer	903001-0003
6	flat washer	903002-0004-02
7	flat bush	902001-0006



NO.	FACTORY'S Part NO.	TX Warehouse No.
		
后制动总成		

1	rear brake assy	405000-0063
1-1	rear brake pads	405008-0009
1-2	rear brake switch cable	405005-0001
1-3	rear brake upper pump assy.	405007-0002/405004-0018
1-4	rear brake oil pipe	405006-0013
1-5	rear brake bottom pump assy.	405007-0009
2	flange bolt	903019-0014-02
3	flange locknut	903007-0002-02
4	flange bolt	903019-0006
5	spring washer	903001-0003
6	flat washer	903002-0004-02

		
前减总成		

1	front fork	501000-0063
2	flange bolt	903018-0034
3	flange locknut	903007-0006

		
转向柱组件		

1	steering column	566000-0005-01
2	steering column bush	902002-0031
3	slotted nut	903008-0009
4	cotter pin	904002-0002-02
5	screw	903013-0021-02
6	upper raiser	601003-0012
7	steering column raiser plate	601004-0018
8	flat washer	903002-0008-02
9	steering pull rod	603001-0009
10	flange bolt	903018-0016
11	clamp bush	902001-0015
12	steering column raiser	601004-0017
13	flange locknut	903007-0004-02



NO.	FACTORY'S Part NO.	TX Warehouse No.
 <p>前轮总成</p>		
1	front tire	401006-0028
FRONT TIRE NEW TREAD PATTERN		401006-0043
2	front hub	401003-0011
3	front rim	401000-0061
4	front brake disc	404001-0016
5	slotted nut	903008-0011
6	cotter pin	904002-0006-02
7	rear axle dust cover	908007-0003
8	bolt	405012-0001/903014-0001
9	right steering knot	603002-0016
10	left steering knot	603002-0015
11	flange locknut	903007-0006
12	oil seal	908001-0024
13	front tire with rim(left/right)	
front tire with rim LEFT NEW PATTERN		401000-0061
front tire with rim RIGHT NEW PATTERN		401000-0061

 <p>后轮总成</p>		
1	rear tyre	402006-0021
2	cotter pin	904002-0006-02
3	rear rim	402000-0067
4	rear axle dust cover	908007-0003
5	slotted nut	903008-0011
6	flange bolt	903018-0029
7	spring washer	903001-0005
8	flat washer	903002-0008
9	rear axle dust washer	505002-0002
10	rear tire with rim(left/right)	
rear tire NEW pattern with rim(left/right)		402008-0026

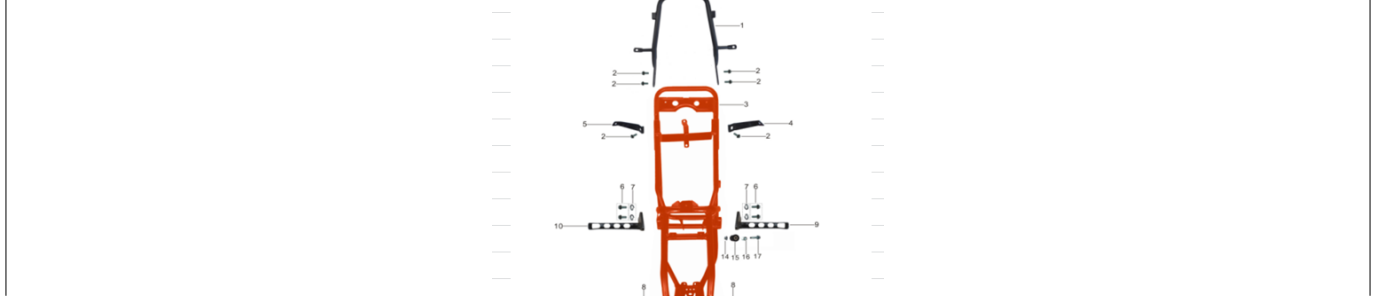

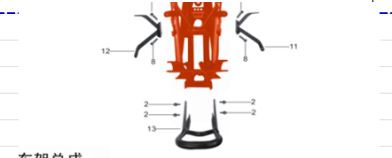
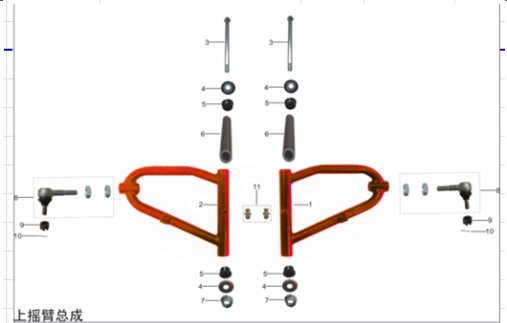
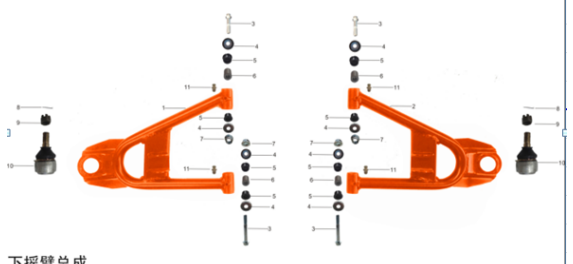

JACKAL 200 / A200

NO.	FACTORY'S Part NO.	TX Warehouse No.
 <p>车架总成</p>		
1	rear bumper	705000-0006-01
2	flange bolt	903019-0013-02
3	frame	561000-0034-01
4	rear left bracket	568000-0044
5	rear right bracket	568000-0045
6	flange bolt	903018-0029
7	flat washer	903002-0008-02
8	screw	903013-0017-02
9	left foot pedal	567000-0004
10	right foot pedal	567000-0005
11	front left bracket	568000-0042-01
12	front right bracket	568000-0043-01
13	front bumper	704000-0008-01
14	flange nut	903007-0004-02
15	chain roller	203004-0016
16	flat bush	902001-0006
17	flange bolt	903018-0013-02
 <p>上摇臂总成</p>		
1	left upper linkage	565000-0010-02
2	right upper linkage	565000-0011-02
3	upper linkage axle	901001-0011
4	seal cover	908007-0006
5	bush	902002-0038
6	flat bush	902001-0041
7	flange locknut	903007-0006
8	linkage ball	603003-0001
9	slotted nut	903008-0010
10	cotter pin	904002-0002-02
11	oil cup	
 <p>下摇臂总成</p>		
1	right lower linkage	565000-0013-01
2	left lower linkage	565000-0012-01
3	flange bolt	903019-0021
4	seal cover	908007-0006
5	bush	902002-0038
6	flat bush	902001-0039
7	flange locknut	903007-0006
8	cotter pin	904002-0002-02



JACKAL 200 / A200

NO.	FACTORY'S Part NO.	TX Warehouse No.
9	slotted nut	903008-0010
10	linkage ball	603003-0006
11	oil cup	

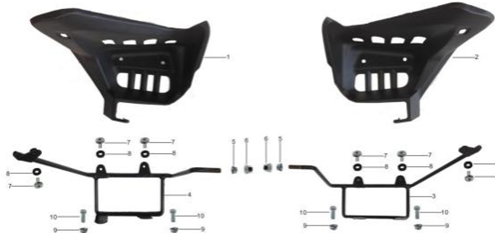

1	right plastic foot pedal	803007-0012
2	left plastic foot pedal	803007-0011
3	left foot pedal bracket	568000-0038-01
4	right foot pedal bracket	568000-0039-01
5	flange nut	903006-0003-02
6	flange locknut	903007-0004-02
7	screw	903012-0007-02
8	flat washer	908003-0002
9	flange locknut	903007-0004-02
10	screw	903013-0017-02

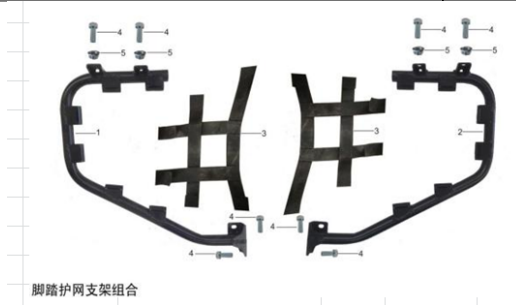

脚踏护网支架组合

1	left mesh foot pedal bracket	568000-0040-01
2	right foot pedal mesh bracket	568000-0041-01
3	front foot pedal mesh	567000-0006
4	screw	903013-0017-02
5	flange locknut	903007-0004-02



后平叉总成

1	swing arm	563000-0006-01
2	rear swing arm assy.	563000-0006-01
3	flange axle	901001-0037
4	bearing	907002-0005
5	dust cover	908007-0001
6	swing arm front bush	902002-0037
7	flange locknut	903007-0011
8	chain slider	203004-0026
9	flange bolt	903019-0012-02
10	mount rubber bush	103003-0002
11	mount bush	103003-0001



JACKAL 200 / A200

NO.	FACTORY'S Part NO.	TX Warehouse No.
12	chain	203000-0070
12*1	chain clip	203001-0006
13	screw	903013-0028
14	swing arm rasier	568000-0035
15	swing arm lower rasier	568000-0036
16	swing arm protector	803007-0010
17	flange bolt	903019-0006



1	rear shock	502000-0053
2	flange axle	901001-0013
3	flange locknut	903007-0008



1	brake pedal	406001-0031
2	rear brake spring	407003-0008
3	flat washer	903002-0005-02
4	flange bolt	903019-0012-02



1	ZS250 engine with Kayo logo	101000-0414
	Engine gasket set	
	STARTER	
	spark plug	
2	front bush	902001-0018
3	support plate	568000-0034
4	bolt	903019-0024
5	flange locknut	903007-0006
6	flange bolt	903018-0026/903018-0047
7	flange locknut	903007-0004-02
8	flange bolt	903019-0012-02
9	bolt	903017-0017



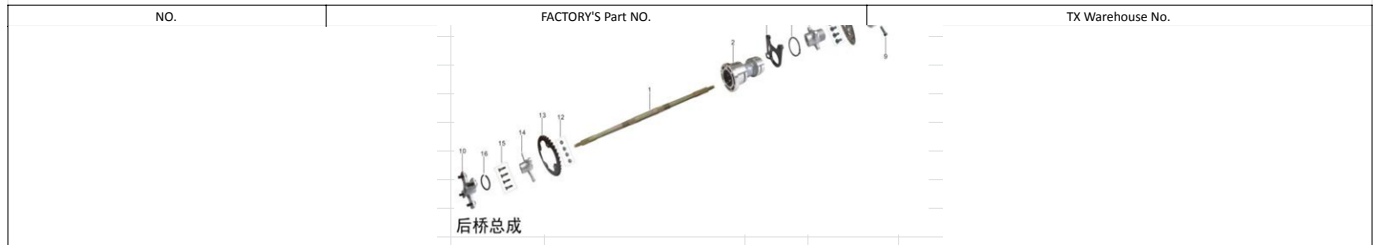

后桥总成

NO.	FACTORY'S Part NO.	TX Warehouse No.
1	rear axle	505001-0010
2	rear alloy axle base	505002-0004
3	mount bracket	568000-0047
4	spring baffle ring	903004-0007
5	rear disc base	205003-0002
6	front brake disc bolt	903013-0017-02
7	rear brake disc	405001-0015
8	rear axle lock bush	205003-0003
9	screw	903014-0003
10	rear hub	402003-0014
11	baffle ring	903004-0003
12	flange locknut	903007-0005
13	black rear sprocket	205001-0019
14	rear sprocket base	
15	screw	
16	baffle ring	



化油器与空滤器总成

1	W270017	102000-0035
2	flange nut	903006-0002-02
3	hoop	906001-0002
4	rubber intake hose	105003-0007
5	mount ring	105004-0007
6	flange locknut	903006-0001-02
7	mount ring	105004-0008
8	nut	903005-0002
9	screw	903009-0006-02
10	air filter sponge bracket	105004-0009
11	air filter sponge	105002-0007
12	bolt	903020-0008
13	air filter shell	105001-0004
14	CDI mount plate	315003-0002
15	relay mount plate	315001-0001



消音器总成

1	black muffler	106002-0020
2	exhaust pipe	106001-0070
2*1	seal gasket	106003-0001
3	flange locknut	903007-0004-02
4	flange bolt	903019-0012-02



JACKAL 200 / A200

NO.	FACTORY'S Part NO.	TX Warehouse No.
5	flange bolt 101029-0812	903019-0013-02



电器组件

1	wire harness	309001-0070
2	relay	301001-0004
3	electric lock	314001-0002-03
4	neutral indicator light	308004-0001
5	reverse indicator light	308004-0002
6	flange bolt	903018-0008-02
7	ignition coil	306001-0011
8	tail light	308002-0004
9	rectifier	302001-0004
10	CDI	303001-0004
11	flange bolt	903018-0004-02
12	flange locknut	903007-0002-02
13	flat washer	903002-0002-02
14	flange bolt	903018-0004-02
15	flange bolt	903018-0008-02
16	battery	312001-0014
	battery	312001-0032
17	battery fixer	315012-0003
18	reflector	308006-0011
19	high beam light	308004-0003
20	low beam light	



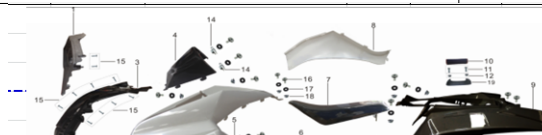

油箱总成

1	fuel tank	805002-0008
1-1	fuel tank-new	805002-0016
1-2	fuel tank cap	805003-0010
2	bolt	903020-0005
3	flat washer	903002-0008-02
4	fuel filter	108001-0001
5	fuel line clip	906002-0001
6	fuel line clip	906002-0001
		108001-0001



KAYO USA

JACKAL 200 / A200

NO.	FACTORY'S Part NO.	TX Warehouse No.
 <p>覆盖件组件</p>		
1	1 piece with front bumper/black right light holder	
2	1 piece with front bumper/-black left light holder	
3	front bumper with left and right light holder(1 piece)	803007-0009
4	black hood/head cover	803007-0008
5	white front cover	803007-0001
6	white left cover	803007-0004
7	seat cover	
	seat	701000-0022
	seat sponge	
8	white right cover	9
9	white rear cover	803007-0003
	black rear cover	803007-0003
10	handrail cover	602005-0005
11	screw	903013-0021-02
12	flange locknut	903007-0004-02
13	black left handrail	803007-0006
14	nut	903008-0020-2
15	screw	903010-0007
16	screw	903012-0007-02
17	rubber flat washer	908003-0002
18	flange locknut	
19	black right handrail	803007-0007
Note: for unlisted bolts, pls take No.16.17.18 for reference.		
		
1	sticker-MOQ=21sets	804005-0001